

DATE	NAME	NO.
AUGUST 25, 1981	INTERSTATE LAND CONSULTANTS, RT#617	
FEBRUARY 1988	517 PROFESSIONAL BLDG. R.D.2.	
JANUARY 1989	HACKETTSTOWN	
JULY 25, 1987	MASER, SOSINSKI & ASSOCIATES	23782
JUNE 25, 1998	BY THOMAS & HERITS, P.E. & L.S.	
JUNE 7, 1999	MASER CONSULTING P.A.	39402
SEPT. 30, 1999	BY LEONARDO E. PONZIO, L.S.	
DECEMBER 31, 2000	LEONARDO E. PONZIO, L.S.	39402
MARCH 5, 2002	LEONARDO E. PONZIO, L.S.	39402
DECEMBER 2002	LEONARDO E. PONZIO, L.S.	39402
OCTOBER 2004	JOHN J. HANLON, P.L.S.	37589
NOVEMBER 2005	RICHARD W. CARLSON, P.L.S.	18207
OCTOBER 2005	RICHARD W. CARLSON, P.L.S.	18207
OCTOBER 2006	RICHARD W. CARLSON, P.L.S.	18207
OCTOBER 2008	WILLIAM G. BERGH, P.L.S.	23846
APRIL 2010	WILLIAM G. BERGH, P.L.S.	GS23846

EVEN NUMBERS INDICATE SECOND FLOOR UNITS
 ODD NUMBERS INDICATE FIRST FLOOR UNITS

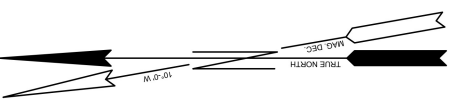
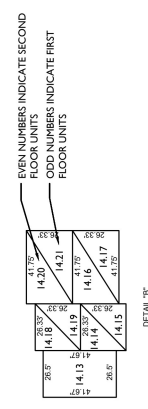
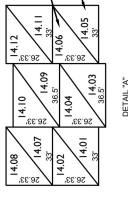

DIVISION OF TAXATION
 SIGNED BY: JAMES J. COLL
 SANTO C. DIDONATO
 DATED: NOV. 14, 2003
 SERIAL NO.: 820

TAX MAP
 TOWN OF HACKETTSTOWN
 WARREN COUNTY, NEW JERSEY
 SCALE 1"=100' FEBRUARY, 1961
 HOWARD L. BOSWELL, P.E. & L.S.
 BOSWELL ENGINEERING CO., RIDGEFIELD PARK, N.J.

THIS TAX MAP SHEET IS A DIGITIZED COPY OF THE TAX MAP ORIGINALLY PREPARED BY HOWARD L. BOSWELL, P.E. & L.S. DATED FEBRUARY, 1961 AND REVISED THROUGH JUNE 25, 1998. THE ORIGINAL TRACINGS ARE FILED IN THE TAX ASSESSORS OFFICE.

SHEET 4

SHEET 6

SHEET 10

SHEET 11